

125 SXS

KTM
SPORTMOTORCYCLES

ERGAENZUNG ZUM ERSATZTEILKATALOG ART.NR. 3.204.78

125/200 SX, MXC, EXC MOTOR

SUPPLEMENT TO SPARE PARTS MANUAL ART.NR. 3.204.78

125/200 SX, MXC, EXC ENGINE

2000

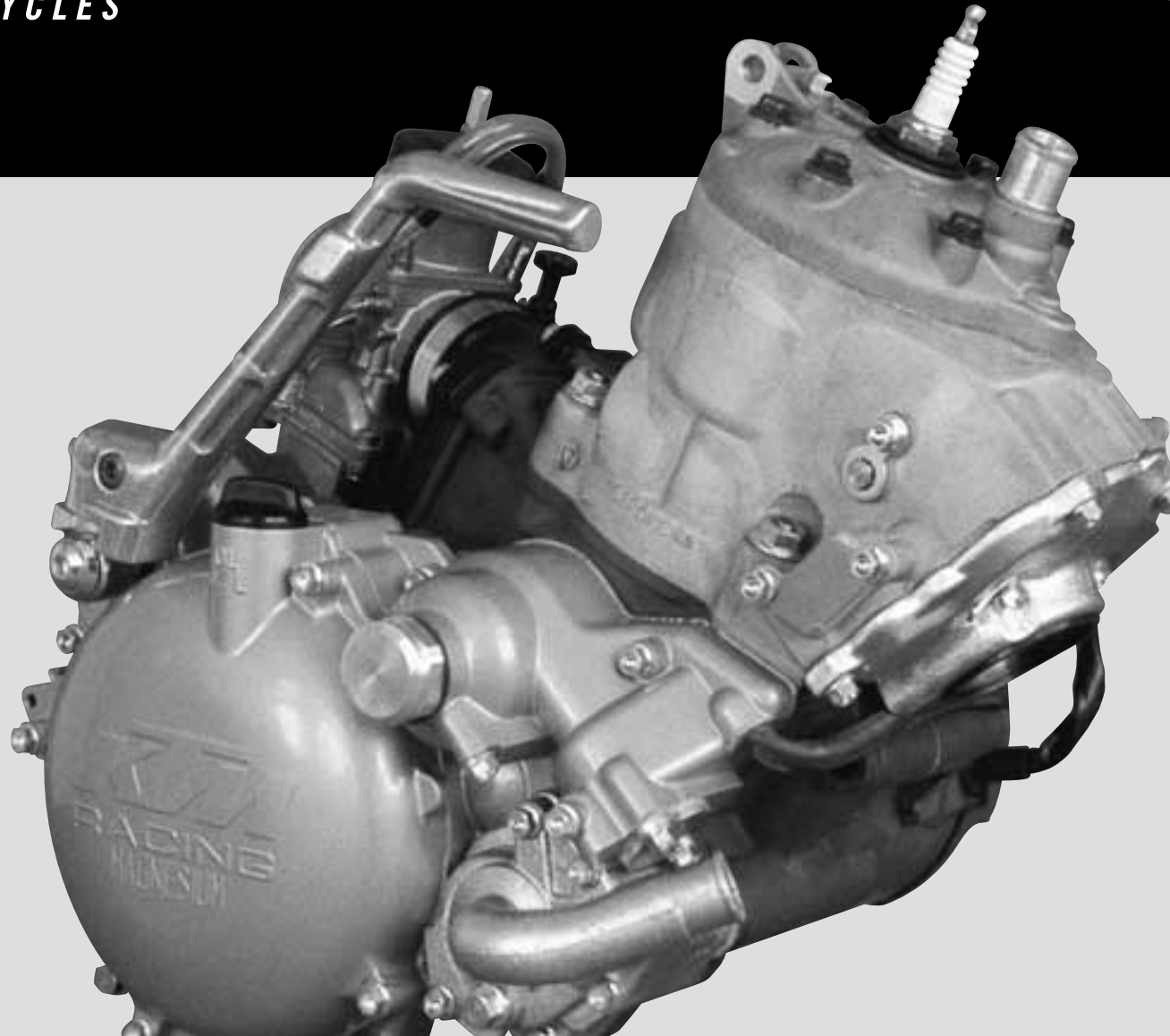

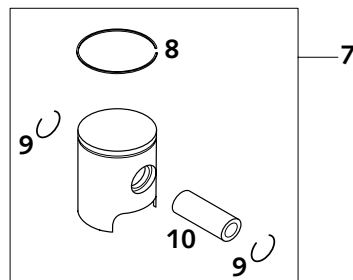
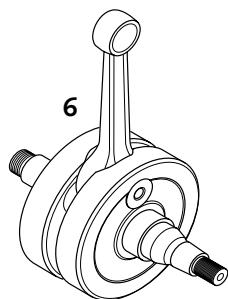
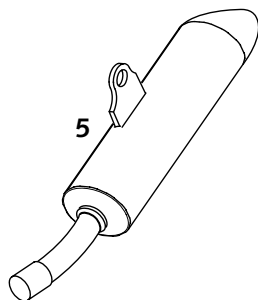
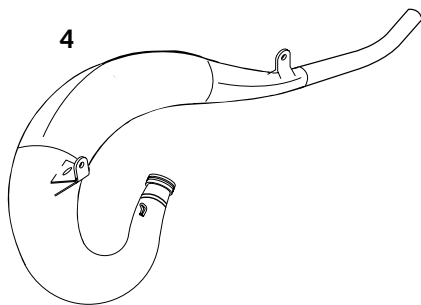
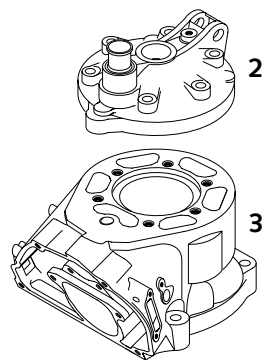
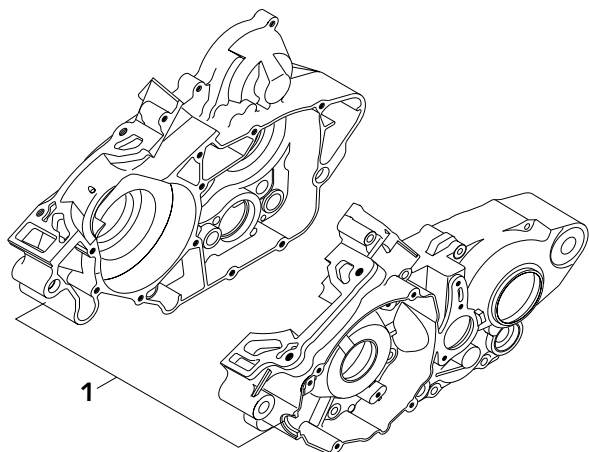

FIG	TEILNR/PARTNR	BEZEICHNUNG	DESCRIPTION	QTY
1	523.30.000.010	MOTORGEHÄUSE CNC BEARBEITET'98	ENGINE CASE CNC TREATED '98	1
2	503.30.006.300	ZYLINDERKOPF 125 EXC 2001	CYLINDER HEAD 125 EXC 2001	1
3	SXS.00.125.001	ZYLINDER 54MM 125 SXS 2000	CYLINDER 54MM 125 SXS 2000	1
4	SXS.00.125.500	AUSPUFF 125 SXS 2000	EXHAUST PIPE 125 SXS 2000	1
5	SXS.00.125.550	ENDDÄMPFER 125 SXS 2000	SILENCER 125 SXS 2000	1
6	503.30.018.200	KURBELWELLE HUB 54,5 2001	CRANKSHAFT STROKE 54,5 2001	1
7	503.30.007.500/ I	KOLBEN I KPL.54MM 125 2001 EINRING	PISTON I CPL.54MM 125 2001 ONE RING	1
7	503.30.007.500/ II	KOLBEN II KPL.54MM 125 2001 EINRING	PISTON II CPL.54MM 125 2001 ONE RING	1
8	503.30.032.500	RECHTECKRING 54X1 2001	SQUARE RING 54X1 2001	1
9	503.30.074.500	DRAHTSPRENGRING 15X1	WIRE LOCK RING 15X1	2
10	503.30.033.500	KOLBENBOLZEN 15X45,2 2001	PISTON PIN 15X45,2 2001	1

